



Speedglas™
Welding Safety



3M™ Speedglas™ Welding Helmet 9100XXi Air

To optimise the effective lifetime of your welding equipment and avoid the additional cost of replacement, regular maintenance is important. Replace all damaged parts immediately to ensure correct levels of protection. Below is a helpful overview; always read and follow User Instructions.

Before use

- ① **Helmet and head harness.** Inspect for cracks or any damaged parts. Replace if needed.
- ② **Cover lenses.** To provide the best possible vision, they should be clean and without scratches.
- ③ **Face seal.** If the face seal is damaged there is a great risk that contaminated air will get inside the helmet. Verify it's in position and free from splits and tears.
- ④ **Welding filter.** Ensure that the low battery indicator is not flashing and check that the sensors are clean and uncovered.
- ⑤ **Breathing tube.** Confirm that the tube is not damaged or leaking any air. To extend the life of the breathing tube, use a tube cover or a heavy-duty breathing tube.

After use

- ① **Clean the helmet.** Wipe with a moist tissue or cloth, both inside and outside the helmet. If you suspect that the inside of the breathing tube is dirty, it must be changed. DO NOT rinse, immerse in water or clean with solvents.
- ② **Face seal and sweatband.** Remove for additional cleaning as needed and replace if they have splits or tears or whenever they become unhygienic.
- ③ **Cover lenses and visor.** Clean with a soft cloth and replace if any pits or scratches occur.
- ④ **Breathing tube.** Replace if damaged, deformed or leaking any air.
- ⑤ **Storage.** Store the helmet in a dry, clean area away from direct sunlight, high temperatures and solvents.

Spare parts and consumables

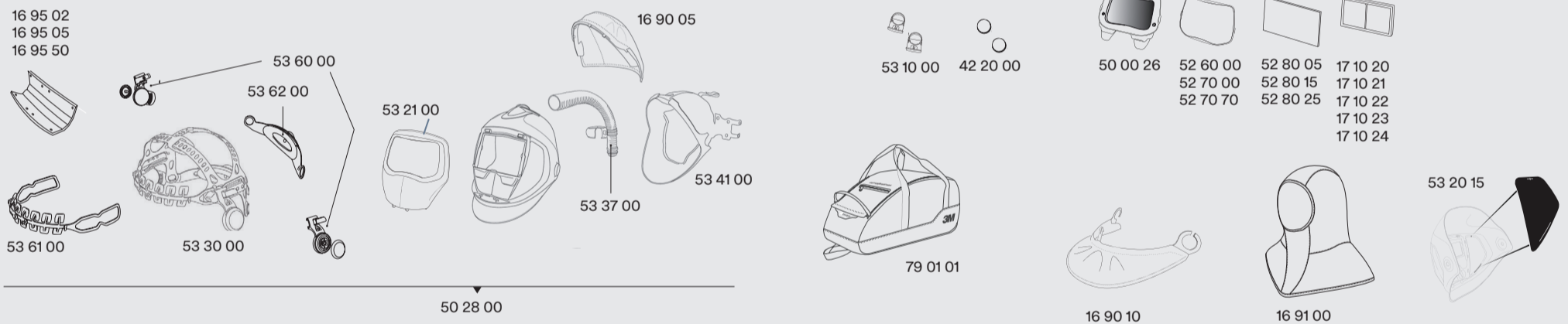

Part No	Description	Part No	Description	Part No	Description
16 90 05	Head Protection 9100	42 20 00	Battery Lithium 9100, 100 & 9000 Pk=2	53 21 00	Front Cover Silver 9100XXi
16 90 10	Throat Protection 9100	50 00 26	Lens Welding 9100XXi Speedglas	53 30 00	Head Harness 9100
16 91 00	Head Cape Tecaweld	50 28 00	Helmet Welding 9100 Air Exc Lens	53 37 00	Air Duct Back Part 9100 Air
16 95 02	Sweatband 9100 & 9100 FX Pk=2	52 60 00	Lens Cover Outer Standard 9100 Pk=10	53 41 00	Face Seal 9100 Air
16 95 05	Sweatband 9100 & 9100 FX Pk=5	52 70 00	Lens Cover Outer Hard Coated 9100 Pk=10	53 60 00	Head Harness Pivot Mechanism 9100
16 95 50	Sweatband 9100 & 9100 FX Pk=50	52 70 70	Lens Cover Outer High Heat 9100 Pk=10	53 61 00	Head Harness Front Part 9100
17 10 20	Lens Magnifying 1.0X G5-01, 9100, 100 & 9000	52 80 05	Lens Cover Inner 9100V Pk=5	53 62 00	Head Harness Back Part 9100
17 10 21	Lens Magnifying 1.5X G5-01, 9100, 100 & 9000	52 80 15	Lens Cover Inner 9100X Pk=5	79 01 01	Carry Bag Speedglas
17 10 22	Lens Magnifying 2.0X G5-01, 9100, 100 & 9000	52 80 25	Lens Cover Inner 9100XX/XXi Pk=5		
17 10 23	Lens Magnifying 2.5X G5-01, 9100, 100 & 9000	53 10 00	Holder Battery 9100		
17 10 24	Lens Magnifying 3.0X G5-01, 9100, 100 & 9000	53 20 15	Cover Plates SW 9100 Pk=2		

www.apexweldingsafety.com.au

[facebook.com/apexweldingsafety](https://www.facebook.com/apexweldingsafety)

[instagram.com/3MSpeedglas](https://www.instagram.com/3MSpeedglas)

[youtube.com/awsspeedglas](https://www.youtube.com/awsspeedglas)

SPATA
Speedglas Powered Air Training Academy

The **Speedglas Powered Air Training Academy (SPATA)** has been launched in Australia and NZ to provide workplaces with online video training modules to educate and train staff on the proper use, care, and maintenance of their welding respiratory protective equipment. Get the most out of your gear and sign up for **FREE** today!

www.apexweldingsafety.com.au/spata

NEW



ALPHA WELD
SUPPLY GROUP
We make it easy!

A 9 Barrel Way, Canning Vale WA 6155
P 08 9456 8000
E sales@alphaweld.com.au

www.alphaweld.com.au

